

TSM

TUBULAR SPECIALTIES MFG., INC.

13011 S. SPRING ST., LOS ANGELES, CA 90061-1685 • 213/515-4801 TOLL FREE 800/421-2961 CA ONLY 800/521-7548
DESIGNER SERVICE: 7:00 A.M. TO 5:00 P.M. PACIFIC TIME • TELEX II: 910-346-6362 • FAX: 213/217-0653

SD-2

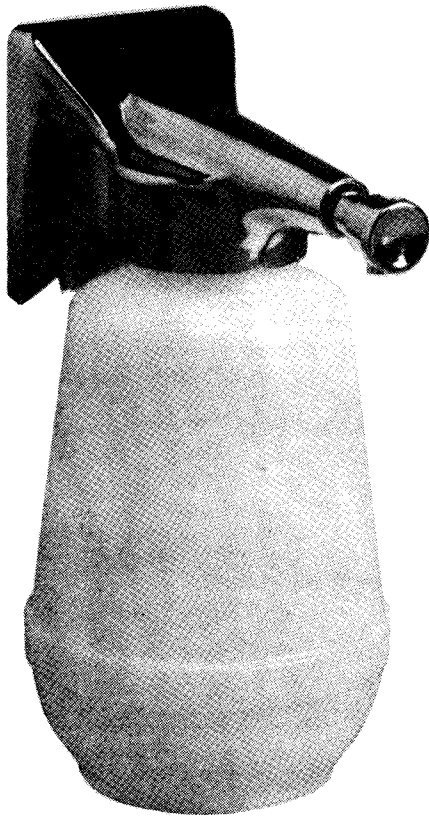

LIQUID/LOTION SOAP DISPENSER



DESIGN CONSIDERATIONS

- The SD-2 is the most economical liquid/lotion soap dispenser in the TSM line.



OPERATION

Valve pushes in to dispense soap. If necessary, valve may be primed by holding finger over spout during outward stroke until soap flows smoothly. Accepts liquid or lotion soaps (for best performance, use vegetable-base soap with a 10-20% soap concentration).



SUGGESTED ARCHITECTURAL SPECIFICATION

TSM model SD-2 Liquid/Lotion Soap Dispenser from Tubular Specialties Manufacturing, Inc., Los Angeles, California, (213) 515-4801. Dispenser: chrome-plated brass with separate wall mounting bracket. Valve: all parts in contact with soap are stainless steel. Soap Globe: translucent polyethylene. Capacity: 16 ounces (0.5 liter). Manufacturer's name is not shown on any exposed surface.



MATERIALS/WORKMANSHIP

Dispenser Body—Bright chrome-plated brass with separate wall plate.

Valve—All metal parts which come in contact with soap are stainless steel.

Soap Globe—Translucent white polyethylene with threaded opening at top to fit into underside of dispenser body. Capacity: 16 fluid ounces (0.5 liter).



INSTALLATION

Dispenser is surface mounted using screws provided by manufacturer at locations marked by an "S" (see Installation, Reference Section C, for various applications). Allow 8" (203mm) wall clearance above lavatory to bottom of wall plate. Dispenser slips over wall plate and is secured by two set screws through bottom of body and plate.

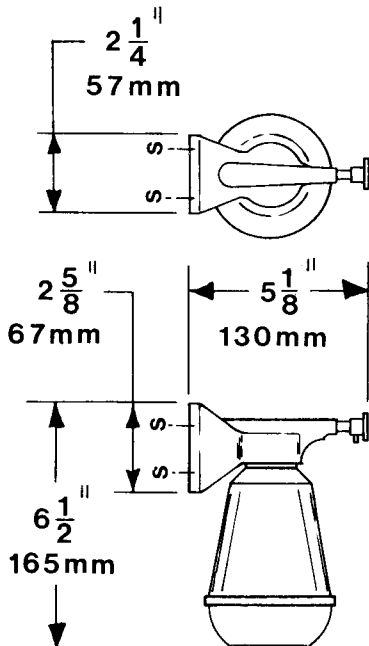

GUARANTEED PRODUCT

SEE PAGE 3 FOR COMPLETE DETAILS